



4 more  
sets please







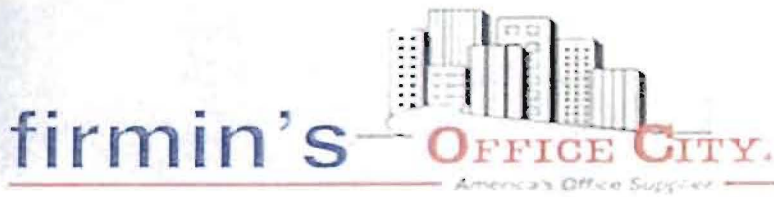

DATE: AUGUST 7, 2014  
 QUOTE TO: TITUS COUNTY - ADULT PROBATION  
 QUOTE FROM: FIRMIN'S OFFICE CITY  
 401 N. JEFFERSON, MT. PLEASANT, TX 75456  
 (903) 572-9871  
 KATHY KOON, FURNITURE SPECIALIST  
[kathy@firmins.com](mailto:kathy@firmins.com)

**OPTION 1**

Line #	MODEL.OPTION(S)	DESCRIPTION	QTY	PRICE	TOTAL	TOTAL	GRAND TOTAL	
1	HON-94284L.NN	94000 SERIES LEFT PEDESTAL DESK 66" X 30"	7	\$678.94	\$4,752.58			
2	HON-94215R.NN	94000 SERIES RIGHT PEDESTAL RETURN 48"X24"	7	\$462.99	\$3,240.93			
3	HON-94244.NN	94000 CREDENZA WITH DOORS	7	\$796.73	\$5,577.11			
4	HON-4022N	LAMINATE KEYBOARD PLATFORM	7	\$50.02	\$350.14			
		FULL LIFETIME WARRANTY/TOTAL PER DESK					\$1,988.68	\$13,920.76
5	HON-HLWU	ENDORSE EXEC. CHAIR	9	\$319.02	\$2,871.18		\$2,871.18	
6	LLR-69169	CHAIR MAT	9	\$58.99	\$530.91		\$530.91	
7	HON-4041	OLSEN HIGH DENSITY STACKING CHAIR	12	\$242.13	\$2,905.56		\$2,905.56	
8	ABC-CCFL24609	CONFERENCE TRAINING TABLES	8	\$249.99	\$1,999.92		\$1,999.92	
		<b>GRAND TOTAL</b>						<b>\$22,228.33</b>

**OPTION 2**

Line #	MODEL.OPTION(S)	DESCRIPTION	QTY	PRICE	TOTAL	TOTAL	GRAND TOTAL	
1	BSH-6360MCA203	DOUBLE PEDESTAL DESK	7	\$332.00	\$2,324.00			
2	BSH-6330MCA103	BOX 1/2	7	\$355.00	\$2,485.00			
3	BSH-6330MCA203	BOX 2/2	7	\$355.00	\$2,485.00			
4	BSH-6361MC03	LOW OVERHEAD	7	\$385.00	\$2,695.00			
5	BSH-AC9985503	MULTI-PURPOSE DRAWER	7	\$122.00	\$854.00			
		10 YEAR WARRANTY/TOTAL PER DESK					\$1,549.00	\$10,843.00
5	HON-HLWU	ENDORSE EXEC. CHAIR	9	\$319.02	\$2,871.18		\$2,871.18	
6	LLR-69169	CHAIR MAT	9	\$58.99	\$530.91		\$530.91	
7	HON-4041	OLSEN HIGH DENSITY STACKING CHAIR	12	\$242.13	\$2,905.56		\$2,905.56	
8	ABC-CCFL24609	CONFERENCE TRAINING TABLES	8	\$249.99	\$1,999.92		\$1,999.92	
		<b>GRAND TOTAL</b>						<b>\$19,150.57</b>

\*THESE PRICES DO NOT INCLUDE INSTALLATION. ESTIMATE OF INSTALLATION CHARGES \$4000.00

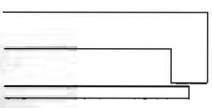
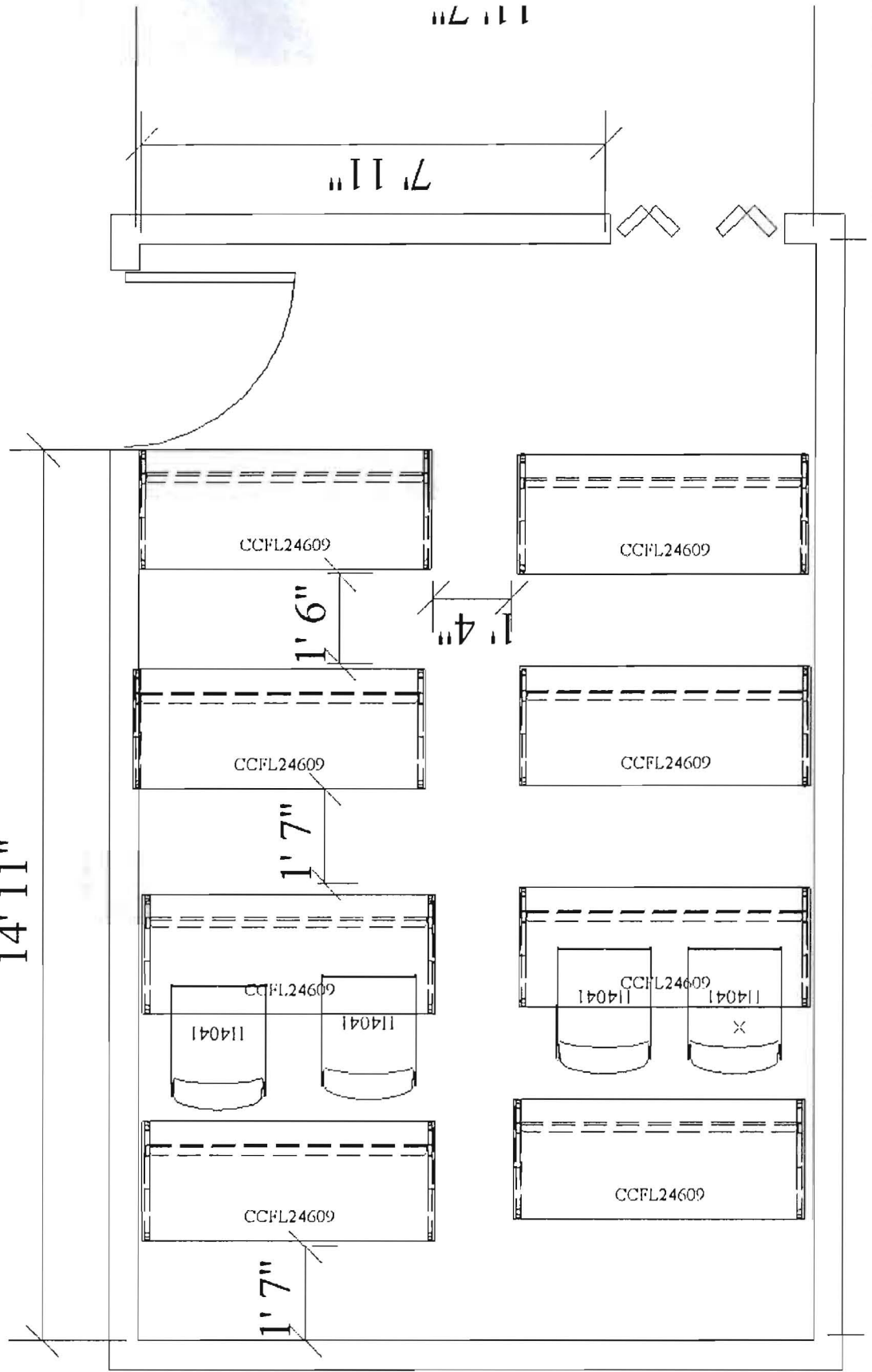
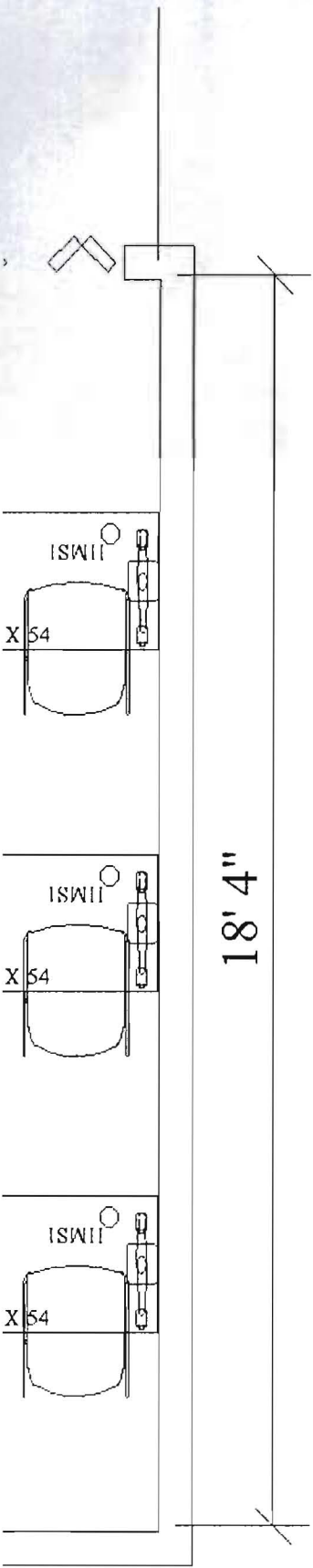



# TLC Office Systems

## ADULT PROBATION PROPOSAL

### PROPOSAL #1:

(7) BBF Syndicate desk Mocha Cherry..... \$12,566.40

Description:	Model number:	Cost:
• Double Pedestal Desk	BSH 6360MCA203	\$ 379.10/ea.
• Box 1/2	BSH 6330MCA103	\$ 413.00/ea.
• Box 2/2	BSH 6330MCA203	\$ 413.00/ea.
• Low overhead	BSH 6361MC03	\$ 448.00/ea.
• Multi-Purpose Drawer	BSH AC9985503	\$ 142.10/ea.

TOTAL PER DESK..... \$1,795.20/ea.

(9) Aspen Executive Chair..... \$ 3,812.40

Description:	Model number:	Cost:
• High Back Adjustable chair	2851-3	\$ 423.60/ea.

Chairs for 7 desks and 2 built in desks

(9) Chair Mats..... \$ 661.50

Description:	Model number:	Cost:
• Rectangle Shape Clear	LLR 69169	\$ 73.50/ea.

Mats for 7 desks and 2 built in desks

(45) Duet High Density Stacking Chair..... \$ 3,677.61

Description:	Model number:	Cost:
• High Density Stacking Chair	662I Black	\$ 83.00/ea.

(14) 2 for each Officer Desk, 15 for Reception Area, 16 for Conference/Training Room

(8) Conference/Training Room Tables..... \$ 2,536.80

Description:	Model number:	Cost:
• 60" W X 24" D table	ABC CCFL24609	\$ 317.10/ea.

Eight Total Desks. Sitting for 16 Persons.

**Total Current Operating Cost..... \$ 23,254.71**

63 Month \$1.00 Buyout Lease Payment..... \$ 511.60

13070 1RR

# SHARP

7/24/2014

Other Locations in Texas to serve you: Houston, Angleton, Woodlands Austin, Longview, Texarkana and Tyler



# TLC Office Systems

## ADULT PROBATION PROPOSAL

### PROPOSAL #2:

(7) HON 94000 SERIES DESKING..... \$23,382.80

Description:	Model number:	Cost:
• Left Pedestal Desk	HON 94284LNN	\$ 1,128.40/ea.
• Right Pedestal Desk	HON 94215RNN	\$ 769.30/ea.
• Credenza With Doors	HON 94244NN	\$ 1,323.70/ea.
• Keyboard Platform	HON 4022N	\$ 119.00/ea.

TOTAL PER DESK..... \$3,340.40/ea.

(9) Aspen Executive Chair..... \$ 3,812.40

Description:	Model number:	Cost:
• High Back Adjustable chair	2851-3	\$ 423.60/ea.

Chairs for 7 desks and 2 built in desks

(9) Chair Mats..... \$ 661.50

Description:	Model number:	Cost:
• Rectangle Shape Clear	LLR 69169	\$ 73.50/ea.

Mats for 7 desks and 2 built in desks

(45) Duet High Density Stacking Chair..... \$ 3,677.61

Description:	Model number:	Cost:
• High Density Stacking Chair	6621 Black	\$ 83.00/ea.

(14) 2 for each Officer Desk, 15 for Reception Area, 16 for Conference/Training Room

(8) Conference/Training Room Tables..... \$ 2,536.80

Description:	Model number:	Cost:
• 60" W X 24" D table	ABC CCFL24609	\$ 317.10/ea.

Eight Total Desks. Sitting for 16 Persons

**Total Current Operating Cost..... \$34,071.11**

63 Month \$1.00 Buyout Lease Payment..... \$ 749.56

# SHARP

7/24/2014

Other Locations in Texas to serve you: Houston, Angleton, Woodlands Austin, Longview, Texarkana and Tyler